



JH STEPHENSON & SON

**PURLIN DESIGN
GARAGE**



KIT GARAGES

- PRE-FABRICATED AND PUNCHED GALVANISED FRAME
- EASY TO ERECT
- CERTIFIED PLANS AND COMPUTATIONS
- MANUFACTURED HERE IN GEELONG



Steeline JH Stephenson is a Geelong based company.

We pride ourselves on service over and above.

So come on in and speak to our friendly sales staff.

GARAGE SIZES - CR BRACKET TYPE



SMALL WIDTH

3.550m (11'6") }
 4.160m (13'6") } 15° Pitch
 4.690m (15'6") }

Heights 2.4m and 2.7m
 Bays 3m Maximum

MEDIUM WIDTH

5.45m (17'6") }
 6.044m (20') } 15° Pitch - Option of 25°
 6.825m (22') } is available
 7.610m (25') }
 8.4m (27'6") }

Heights 2.4m, 2.7m, 3m, 3.3m and 3.6m
 Bays 3m and 4.5m



LARGE WIDTH

9.110m (30') } 10° Pitch
 10.7m (35') }

Heights 2.7m, 3m, 3.6m and 4.2m
 Bays 3m and 4.5m

RURAL WIDTH

12.2m (40') } 10° Pitch
 15m (50') }

Heights 3.6m, 4.2m, 4.5m and 4.8m
 Bays 3m and 4.5m

INDUSTRIAL WIDTH

18m (60') } 5° Pitch
 20m (65'6") }
 24m (80') }

Heights 4.8m, 5m, 5.4m and 6m (Ind)
 Bays 4.5m

FRAME MATERIAL - for the Columns & Rafters

Small Garages.....C100
 Medium Garages.....C150
 Large Garages.....C250
 Rural Garages.....Double C250
 Industrial Sheds.....Double C300 or C400

CLADDING MATERIAL

Corrugated Roofing
 GP Panel Walls
 Multiclad Walls on Industrial Sheds

ACCESSORIES

Roller Doors & Windows of the highest quality.

EASY TO ASSEMBLE FRAME

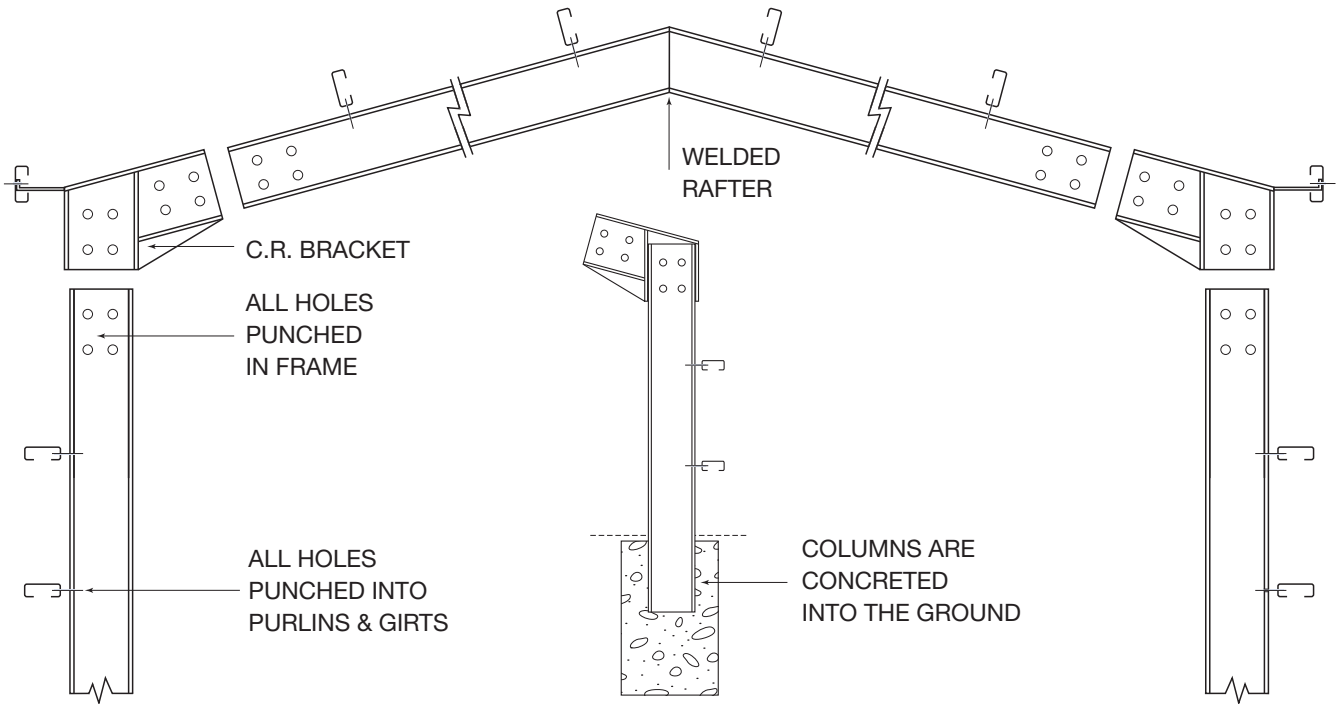

APEX BRACKET

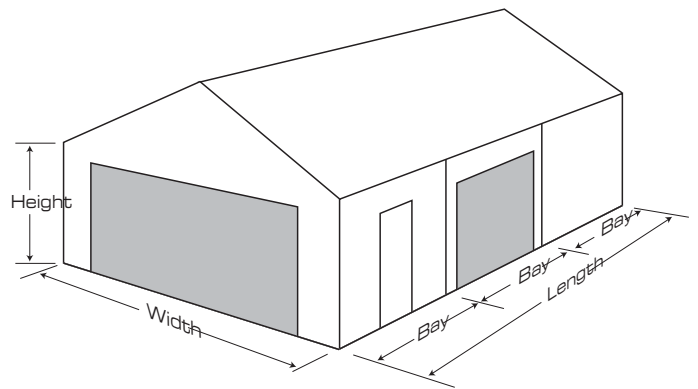

Rollerdoors in Gable or side options



CR BRACKET



SKYLIGHTS, MANDOOR & WINDOWS

OPTIONS



GARAPORT



OPEN BAYS



INTERNAL WALLS



SKILLION GARAGES AND CARPORTS



GABLE CARPORTS



SIDE SKILLIONS / BARN SHEDS



JH STEPHENSON & SON PTY LTD

ABN 52 004 570 370

GEELONG

152 Victoria Street North Geelong 3215

75 Heales Road Corio 3214

Telephone 03 5274 6222

LAVERTON

11 Westside Drive Laverton North 3026

Telephone 03 9314 1044



JH STEPHENSON & SON

www.steeline.com.au

Whilst every care is taken in the preparation of these specifications, JH Stephenson & Son Pty Ltd accept no responsibility for the accuracy of the information supplied.